

DL1-B812

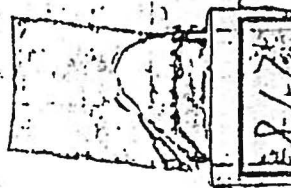

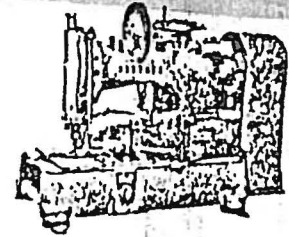

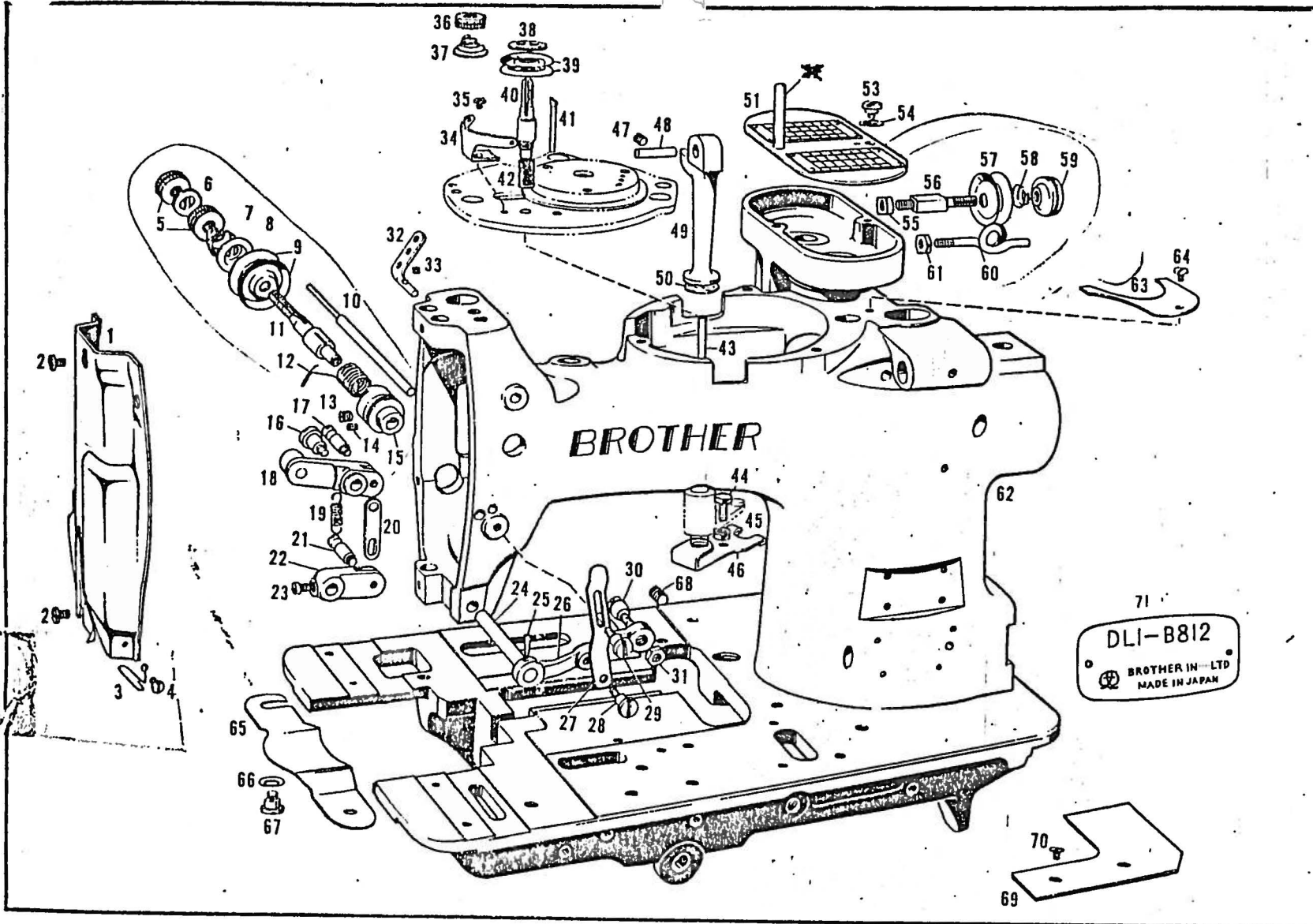

## PARTS LIST for DL1-B812

B812-3

Ref. No.	Name of Parts	Q'ty	Parts No.	Assy No.	Ref. No.	Name of Parts	Q'ty	Parts No.	Assy No.
A-1	Face Plate	1 pce.	107659-0-01		A-46	Tension Thread Release Plate	1 pce.	107609-0-01	
A-2	Set Screw for A-1	2 pcs.	107491-0-02		A-47	Set Screw for A-48	1 "	104649-0-01	
A-3	Thread Guide on A-1	1 pce.	107660-0-01		A-48	Head Supporter Pin	1 "	107314-0-01	
A-4	Set Screw for A-3	1 "	107661-0-01		A-49	Head Supporter	1 "	107312-0-01	
A-5	Tension Control Nut	2 pcs.	107607-0-01		A-50	Head Supporter Leather	1 "	107313-0-01	
A-6	Washer for A-5	1 pce.	107625-0-01		A-51	Gear Case Cover Ass	1 Set.	107010-0-01	
A-7	Tension Spring (B)	1 "	107624-0-01		A-53	Stud Screw for A-51	1 pce.	107321-0-01	
A-8	Tension Disc Washer	1 "	100134-0-01		A-54	Washer for A-53	1 pce.	107017-0-01	
A-9	Tension Disc	2 pcs.	108721-0-01		A-55	Locking Nut for A-56	1 "	107197-0-01	
A-10	Tension Thread Release Pin (B)	1 pce.	107627-0-01		A-56	Bobbin Winder Tension Stud	1 "	107678-0-01	107678-0-01
A-11	Tension Stud Screw (B)	1 "	107619-0-01	1076922	A-57	Bobbin Winder Tension Disc	2 pcs.	107680-0-02	
A-12	Check Spring	1 "	107621-0-01		A-58	Bobbin Winder Tension Spring	1 pce.	107681-0-01	
A-13	Set Screw for A-15	1 "	107086-0-01		A-59	Bobbin Winder Tension Control Screw	1 "	107682-0-01	
A-14	Set Screw for A-11	1 "	100402-0-02		A-60	Thread Guide	1 "	107676-0-01	
A-15	Upper Tread Tension Bracket	1 "	100397-0-01		A-61	Nut for A-60	1 "	107733-0-01	
A-16	Stud Screw for A-22	1 "	107658-0-01		A-62	Armbed	1 set.	108820-0-01	
A-17	Sustainer for A-22	1 "	107657-0-01		A-63	Top Cover for Arm	1 pce.	107011-0-01	
A-18	Upper Thread Pulling Lever	1 "	107655-0-01		A-64	Fastening Screw for A-63	1 "	100257-0-07	
A-19	Spring for A-18	1 "	107656-0-01		A-65	Bed Hinge Plate	1 "	107015-0-01	
A-20	Pulling Plate for A-18	1 "	107654-0-01	107353-0-01	A-66	Washer for A-67	2 pcs.	107017-0-01	
A-21	Sustainer for A-22	1 "	107657-0-01		A-67	Stud Screw for A-65	2 "	107016-0-01	
A-22	Upper Thread Pulling Link	1 "	107652-0-01		A-68	Cap Screw for Oil Hole of F-28	1 pce.	100218-0-02	
A-23	Set Screw for A-22	1 "	107459-0-01		A-69	Base Cover	1 "	107013-0-01	
A-24	Upper Thread Pulling Arm Shaft	1 "	107646-0-01		A-70	Set Screw for Base Cover	2 pcs.	107014-0-02	
A-25	Taper Pin for A-26	1 "	107645-0-02		A-71	Model Plate	1 pce.	110921-0-01	
A-26	Upper Thread Pulling Arm	1 "	107644-0-01		A-72	Model Plate Pin	2 pcs.	116231-0-01	
A-27	Upper Thread Release Plate	1 "	107649-0-01	107347-0-01					
A-28	Stud Screw for A-27	1 "	107650-0-01						
A-29	Stud Screw for A-27	1 "	107650-0-01						
A-30	Ball Stud Screw for A-26	1 "	107647-0-01						
A-31	Nut for A-30	1 "	107114-0-01						
A-32	Thread Retainer	1 "	114931-0-01						
A-33	Set Screw for A-32	1 "	104649-0-01						
A-34	Tension Thread Guide	1 "	107613-0-01						
A-35	Set Screw for A-34	1 "	105160-0-01						
A-36	Tension Control Nut	1 "	107607-0-01						
A-37	Tension Spring (A)	1 "	107606-0-01						
A-38	Tension Disc Washer	1 "	100134-0-01						
A-39	Tension Disc	2 pcs.	108721-0-01						
A-40	Tension Stud Screw (A)	1 pce.	107602-0-01						
A-41	Tension Thread Release Pin (A)	1 "	107612-0-01						
A-42	Spring for A-39	1 "	107603-0-01						
A-43	Tension Thread Release Rod	1 "	107608-0-01						
A-44	Bolt for A-46	1 "	107610-0-01						
A-45	Nut for A-44	1 "	105234-0-01						

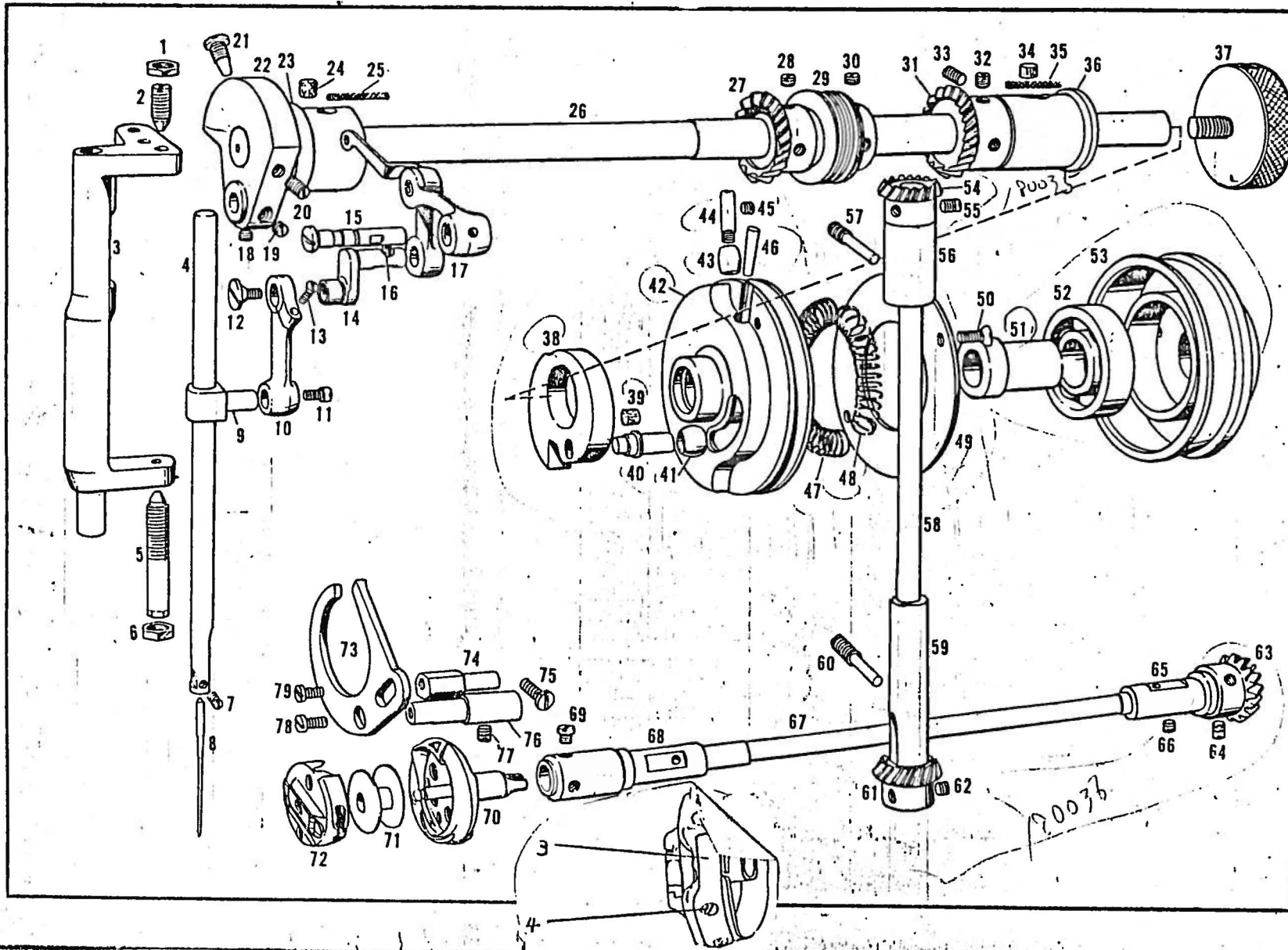



Ref. No.	Name of Parts	Q'ty	Parts No.	Assembly No.	Ref. No.	Name of Parts	Q'ty	Parts No.	Assembly No.
B-1	Nut for B-2	1 pce.	107059-0-01		B-44	Roller Shaft for Arm Pulley	1 pce.	107031-0-01	
B-2	Upper Centre Screw for B-3	1 "	107058-0-01		B-45	Set Screw for B-44	1 "	100218-0-02	182083-0-01
B-3	Needle Bar Support	1 "	107057-0-01		B-49	Pulley Cover	1 "	107037-0-01	
B-4	Needle Bar	1 "	107054-0-01	180034-0-01	B-50	Fastening Screw for B-49	2 pcs.	107038-0-01	
B-5	Lower Centre Screw for B-3	1 "	107060-0-01		B-46	Taper Pin for B-42	1 pce.	107030-0-01	
B-6	Nut for B-5	1 "	107061-0-01		B-47	Plunge Spring (long) 鉄線入ネ	1 "	107034-0-01	
B-7	Set Screw for Needle	1 "	107055-0-01		B-48	Plunge Spring (short)	1 "	107035-0-01	
B-8	Industrial Needle (DPX5)	1 "	107415-0-14		B-51	Bushing for D-52	1 "	107041-0-00	
B-9	Needle Bar Connecting Stud	1 "	107052-0-01		B-52	Ball Bearing 62032 for B-53	1 "	107040-0-00	107020-0-01
B-10	Needle Bar Crank Rod	1 "	107050-0-01		B-53	Idle Pulley	1 "	107039-0-01	
B-11	Clamp Screw for B-9	1 "	100025-0-01		B-54	Upper Spiral Bevel Gear for B-58	1 "	107070-0-01	
B-12	Cap Screw for B-14	1 "	107049-0-01		B-55	Set Screw for B-54	2 pcs.	107071-0-03	180035-0-01
B-13	Adjusting Screw for B-10	1 "	100255-0-02	107021-0-01	B-31	Upper Shaft Spiral Bevel Gear	1 pce.	107067-0-01	
B-14	Needle Bar Crank	1 "	107046-0-01		B-32	Set Screw for B-31	1 "	100251-0-01	
B-15	Thread Take up Lever Supporter Shaft	1 "	107065-0-01		B-56	Upper Bushing for B-58	1 "	107073-0-00	
B-17	Thread Take up Link	1 "	107062-0-01		B-57	Set Screw for B-56	1 "	107074-0-01	
B-16	Set Screw for B-15	1 "	100016-0-03		B-58	Vertical Shaft	1 "	107072-0-01	
B-18	Set Screw for B-14 & B-22	1 "	100251-0-01		B-59	Lower Bushing for B-58	1 "	107075-0-00	
B-19	Set Screw for B-14 & B-22	1 "	101706-0-01		B-60	Set Screw for B-59	1 "	107076-0-01	
B-20	Screw for B-22	1 "	107045-0-01		B-61	Lower Spiral Bevel Gear for B-58	1 "	107077-0-01	
B-21	Position Screw for B-22	1 "	100250-0-01		B-62	Set Screw for B-61	2 pcs.	100251-0-01	
B-22	Balance Crank	1 "	107019-0-00	181984-0-01	B-63	Lower Shaft Spiral Bevel Gear	1 pce.	107079-0-01	180036-0-01
B-23	Upper Shaft Bushing (left)	1 "	107019-0-00		B-64	Set Screw for B-63	2 pcs.	115995-0-01	
B-24	Oil Felt for B-23	1 "	107448-0-01		B-65	Lower Shaft Bushing (right)	1 pce.	107085-0-01	
B-25	Wick 4x10 for B-23	1 "	107479-0-01		B-66	Set Screw for B-65	1 "	107086-0-01	
B-26	Upper Shaft	1 "	107018-0-01		B-67	Lower Shaft	1 "	107081-0-01	180929-0-01
B-27	Zigzag Pinion Bevel Gear (B)	1 "	107234-0-01	181988-0-01	B-68	Lower Shaft Bushing (left)	1 "	107087-0-01	
B-28	Set Screw for B-27	1 "	100058-0-03		B-69	Set Screw for B-70	2 pcs.	100366-0-03	
B-29	Worm	1 "	107489-0-01		B-70	Rotary Hook Assembly	1 set.	107089-0-01	180038-0-01
B-30	Set Screw for B-29	1 "	100058-0-03		B-72	Bobbin Case	1 pce.	107097-0-01	
B-31	Upper Shaft Spiral Bevel Gear	1 "	107067-0-01		B-71	Bobbin	1 "	107096-0-01	
B-32	Set Screw for B-31	1 "	100251-0-01		B-73	Rotary Hook Holder Position Bracket	1 "	107090-0-01	
B-33	Set Screw for B-36	1 "	100016-0-01		B-74	Upper Supporter for B-73	1 "	107094-0-01	
B-34	Oil Felt for B-36	1 "	107448-0-01		B-75	Set Screw for B-74	1 "	104908-0-01	
B-35	Wick 4x10 for B-36	1 "	107479-0-01		B-76	Lower Supporter for B-73	1 "	107091-0-01	
B-36	Upper Shaft Bushing (right)	1 "	107022-0-00		B-77	Set Screw for B-76	1 "	100539-0-02	
B-37	Cap Screw for B-53	1 "	107042-0-01		B-78	Set Screw for B73 & B-76	1 "	107093-0-01	
B-38	Stopper Cam	1 "	107025-0-01	182216-0-01	B-79	Set Screw for B-73 & B-74	1 "	103988-0-01	
B-40	Roller Shaft for Stopper Cam	1 "	107026-0-00						
B-39	Wick 7x6 for B-38	2 pce.	107452-0-01						
B-41	Roller for Stopper Cam	1 pce.	107027-0-01	182083-0-01					
B-42	Arm Pulley	1 "	107029-0-01						
B-43	Roller for Arm Pulley	1 "	107033-0-01						

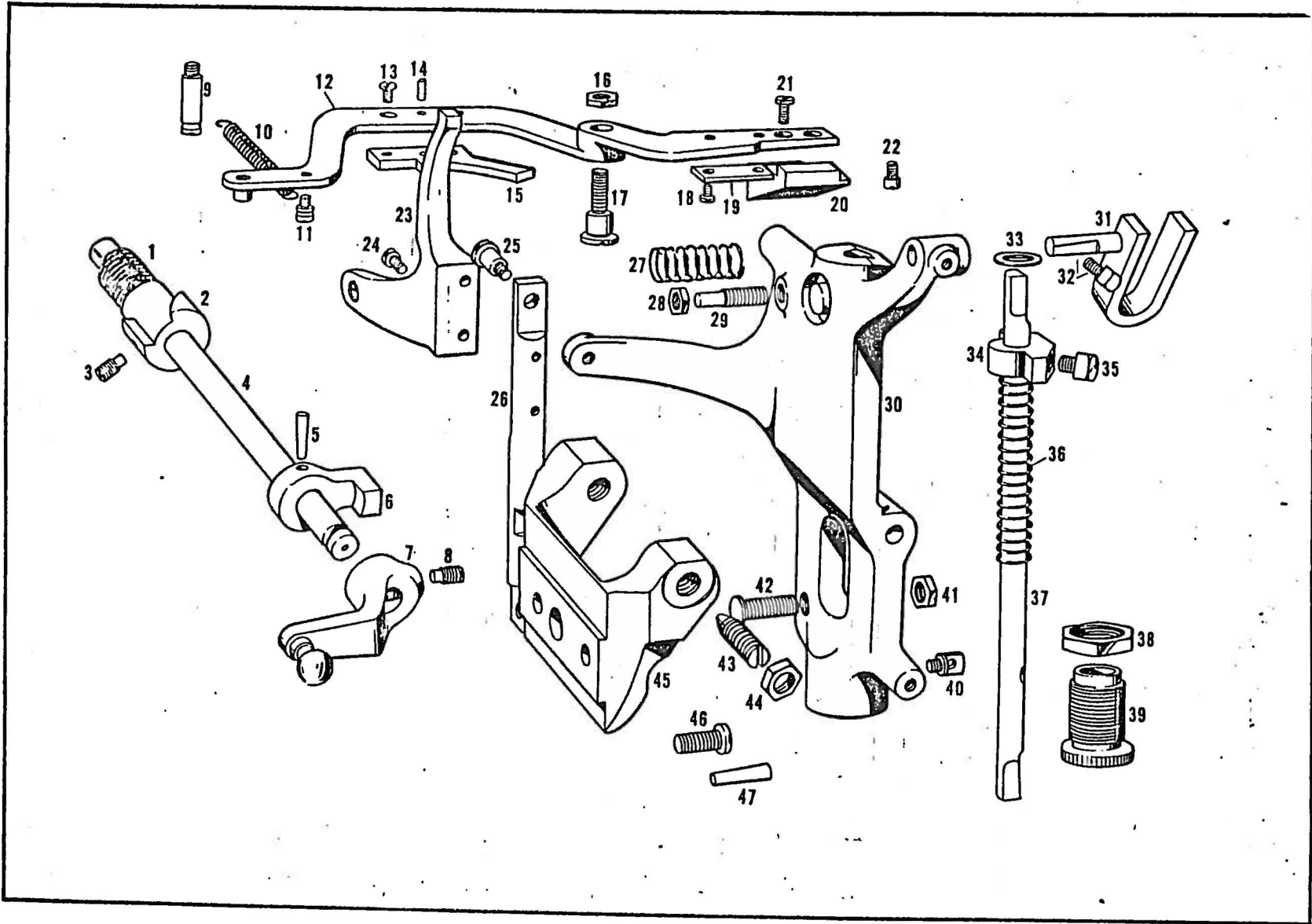



Ref. No.	Name of Parts	Q'ty	Parts No.	Assem. No.	Ref. No.	Name of Parts	Q'ty	Parts No.	As. No.	y
C-1	Emergency Stop Handle Spring	1 pce.	107147-0-01	107139	C-46	Set Screw for C-45	1 pce.	107100-0-01		
C-2	Emergency Stop Cam	1 "	107145-0-00		C-47	Taper Pin for C-45	2 pce.	107005-0-00	100331007	
C-3	Set Screw for C-2	1 "	107141-0-01							
C-4	Emergency Stop Handle Shaft	1 "	107142-0-00							
C-5	Taper Pin for C-6	1 "	107749-0-00							
C-6	Emergency Stoppr	1 "	107143-0-01							
C-7	Emergency Stop Handle Assembly	1 set.	107052-0-01							
C-8	Set Screw for C-7	1 pce.	107141-0-01							
C-9	Sustainer for C-12	1 "	107138-0-01							
C-10	Stop Motion Lever Tension Spring	1 "	107137-0-01							
C-11	Sustainer for Stop Lever Spring	1 "	107126-0-01							
C-12	Stop Motion Lever	1 "	107123-0-01							
C-13	Set Screw for C-15	2 pcs.	100257-0-06							
C-14	Knock Pin for C-15	1 pce.	107131-0-00							
C-15	Stopper Claw <i>W &amp; W</i>	1 "	108818-0-01							
C-16	Nut for C-17	1 "	107059-0-01							
C-17	Stop Motion Lever Stud Screw	1 "	107127-0-01							
C-18	Set Screw for C-19	2 pcs.	100257-0-06							
C-19	Claw Plate for C-26	1 pce.	107132-0-01							
C-20	Belt Shifter Bracket	1 "	107134-0-01							
C-21	Set Screw for C-12	1 "	100137-0-03							
C-22	Stop Screw for C-20	1 "	100522-0-02							
C-23	Clutch Lever	1 "	107121-0-01							
C-24	Set Screw for C-23	2 pcs.	107122-0-01							
C-25	Stud Screw for C-26	1 pce.	107120-0-02							
C-26	Clutch Pulling Lever	1 "	107119-0-01							
C-27	Spring for C-30	1 "	107112-0-01							
C-28	Nut for C-29	1 "	107114-0-01							
C-29	Upper Clutch Stopper Screw	1 "	107113-0-01							
C-30	Clutch Body	1 "	107104-0-01							
C-31	Belt Shifter <i>W &amp; W</i>	1 "	107117-0-01							
C-32	Set Screw for C-31	1 "	107118-0-01							
C-33	Clutch Guide Buffer Leather	1 "	107108-0-01							
C-34	Clutch Guide <i>W &amp; W</i>	1 "	107106-0-01							
C-35	Set Screw for Clutch Guide	1 "	107107-0-01							
C-36	Clutch Spring	1 "	107109-0-01							
C-37	Clutch	1 "	107105-0-01							
C-38	Nut for C-39	2 pcs.	107111-0-01							
C-39	Adjustable Screw for Clutch Spring	1 pce.	107110-0-01							
C-40	Lower Sustainer for 1-32	1 "	107640-0-01							
C-41	Nut for C-42	1 "	107116-0-01							
C-42	Lower Clutch Stopper Screw	1 "	107115-0-01							
C-43	Centre Screw for C-45	2 pcs.	107102-0-01							
C-44	Nut for C-43	2 "	107103-0-01							
C-45	Clutch Bracket	1 pce.	107099-0-01							

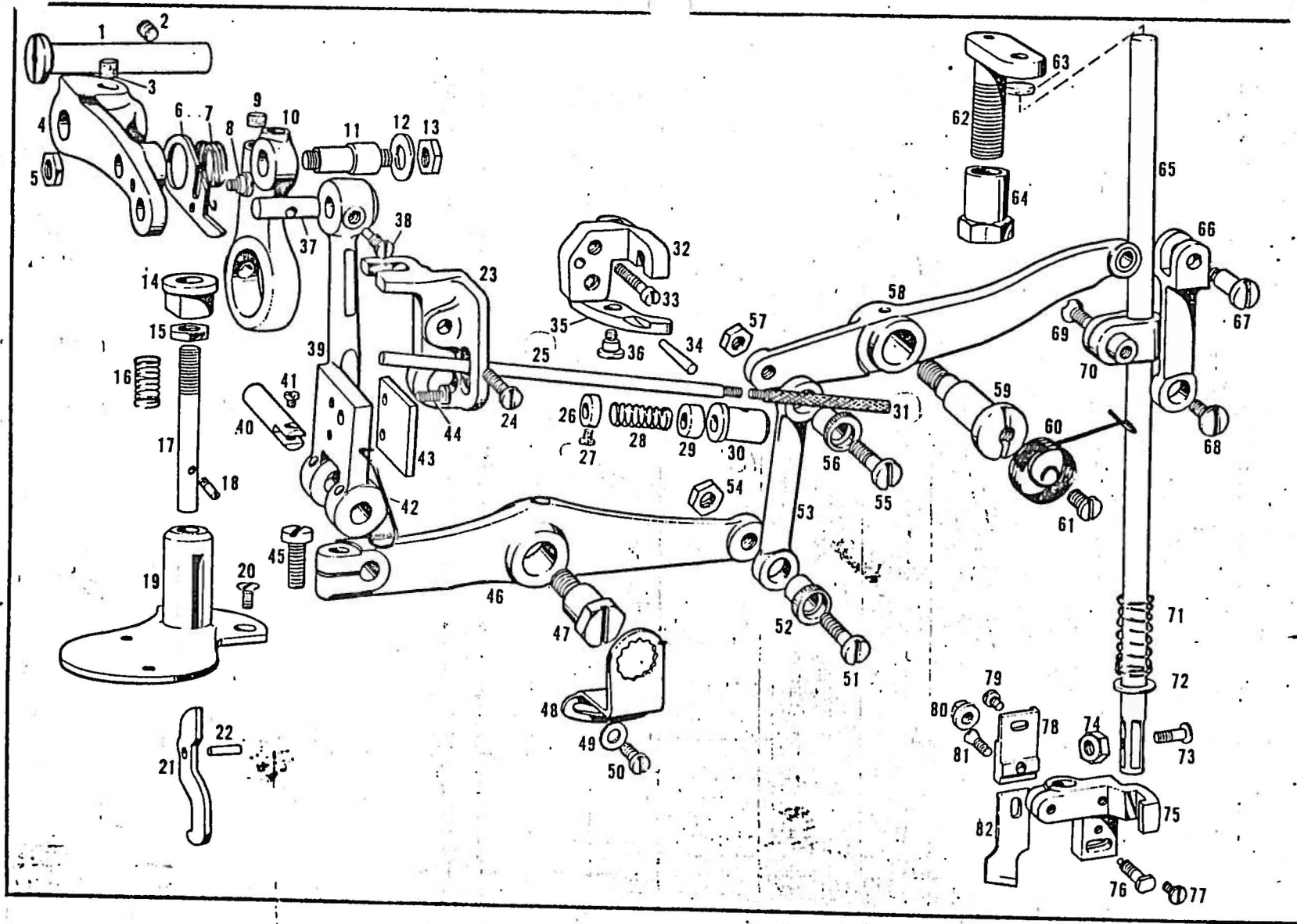



Ref. No.	Name of Parts	Q'ty	Parts No.	Alt. No.	Ref. No.	Name of Parts	Q'ty	Parts No.	Alt. No.
D-1	Cutter Lever Shaft	1 pce.	107156-0-01		D-46	Cutter Lever Lower	1 pce.	107170-0-01	
D-3	Oil Felt for Cutter Lever for D-4	2 pcs.	107149-0-01	107036-0-01	D-47	Stud Screw for D-46	1 "	107172-0-01	
D-4	Cutter Lever	1 Pce.	107154-0-01	80040-0-01	D-48	Bracket for D-47	1 "	107173-0-01	
D-6	Cutter Clutch Stopper Plate Ass'y	1 set.	107044-0-01		D-49	Washer for D-50	1 "	107175-0-01	
D-5	Nut for D-11	1 pce.	107059-0-01		D-50	Set Screw for D-48	1 "	107174-0-01	
D-7	Spring for D-6	1 "	107160-0-01		D-51	Set Screw for D-52	1 "	107178-0-01	
D-8	Stud Screw for D-6	1 "	107161-0-01	107036-0-01	D-52	Cutter Link Bushing	1 "	107177-0-01	
D-9	Oil Felt for D-10	2 pcs.	107149-0-01		D-53	Cutter Link <i>4.7-4.7</i>	1 "	107176-0-01	10705100
D-10	Cutter Crank Rod	1 pce.	107148-0-01		D-54	Nut for D-51	1 "	107435-0-01	
D-11	Cutter Crenk Rod Shaft	1 "	107151-0-01		D-55	Set Screw for D-56	1 "	107178-0-01	
D-13	Nut for D-11	1 "	107059-0-01	180039-0-01	D-56	Cutter Link Bushing	1 "	107177-0-01	
D-12	Washer for D-11	1 "	107153-0-01		D-57	Nut for D-55	1 "	107435-0-01	
D-2	Set Screw for D-1	1 "	107157-0-01		D-58	Cutter Lever Upper <i>4.9-7.1</i>	1 "	107186-0-01	18196400
D-14	Cutter Lever Holder	1 "	107223-0-01		D-59	Stud Screw for D-58	1 "	107181-0-01	
D-15	Nut for D-14	1 "	107059-0-01		D-60	Spring for D-58	1 "	107182-0-01	
D-16	Spring for D-17	1 "	107227-0-01		D-61	Set Screw for D-60	1 "	107183-0-01	
D-17	Cutter Lever Connecting Bar	1 "	107225-0-01		D-62	Cutter Bar Stopper	1 "	107180-0-01	4.71814
D-18	Guide Screw for D-17	1 "	107226-0-01	107082-0-01	D-63	Fibre for D-62	1 "	107193-0-01	107068-0-01
D-19	Cutter Lever Holding Bracket	1 "	107228-0-01		D-64	Nut for D-62	1 "	107194-0-01	
D-20	Set Screw for D-19	2 pcs.	107231-0-01		D-66	Cutter Bar Connecting Rod <i>10.7066</i>	1 "	107184-0-01	
D-21	Cutter Safety	1 pce.	107229-0-01		D-67	Stud Screw for D-66	1 "	107185-0-01	
D-22	Taper Pin for D-21	1 "	107230-0-01		D-68	Cap Screw for D-66	1 "	107186-0-01	107066-0-01
D-23	Cutter Clutch Guide	1 "	107232-0-01		D-69	Set Screw for D-70	1 "	107188-0-01	
D-24	Set Screw for D-23	1 "	100560-0-03		D-70	Cutter Bar Connecting Stud	1 "	107187-0-01	
D-25	Cutter Clutch Pressure Bar (long)	1 "	107211-0-01		D-71	Cutter Bar Spring	1 "	107191-0-01	
D-26	Set Collar for D-25	1 "	107214-0-01		D-72	Cutter Bar washer	1 "	107190-0-01	
D-27	Set Screw for D-26	1 "	107215-0-01		D-65	Cutter Bar	1 "	107189-0-01	
D-28	Spring for D-26	1 "	107216-0-01		D-73	Set Screw for D-75	1 "	107196-0-01	
D-29	Washer for D-25	1 "	107217-0-01		D-74	Nut for D-73	1 "	105254-0-01	112106
D-30	Cutter Clutch Bar Joint	1 "	107213-0-01		D-75	Cutter Holder <i>4.7 7.7 11.7</i>	1 "	107195-0-01	107069-0-01
D-31	Cutter Clutch Pressure Bar (short)	1 "	107212-0-01		D-76	Stud Screw for Cutter <i>4.7 7.7 11.7</i>	1 "	107202-0-01	107069-0-01
D-32	Cutter Cam Finger Bracket	1 "	107218-0-01		D-77	Set Screw for D-76	1 "	107203-0-01	
D-35	Cutter Cam Finger	1 "	107221-0-01		D-78	Cutter Guide	1 "	107199-0-01	
D-36	Stud Screw for D-35	1 "	107222-0-01	107080-0-01	D-79	Set Screw for D-78	1 "	100257-0-06	
D-33	Set Screw for D-32	2 pcs.	107219-0-01		D-80	Nut for D-76	1 "	115269-0-01	107201
D-34	Taper Pin for D-32	1 pce.	107030-0-01		D-81	Set Screw for D-75	1 "	100255-0-02	
D-37	Cutter Clutch Pin	1 "	107162-0-01		D-82	Cutter <i>1/8" 11.1125</i>	1 "	107204-0-01	
D-38	Set Screw for D-37	1 "	107163-0-01		D-82	Cutter <i>1/8" 12.7000</i>	1 "	107200-0-01	
D-39	Cutter Clutch Body	1 "	107164-0-01		D-82	Cutter <i>3/8" 15.275</i>	1 "	107205-0-01	
D-40	Cutter Clutch Shaft	1 "	107167-0-01		D-82	Cutter <i>3/8" 9.525</i>	1 "	109837-0-01	
D-41	Set Screw for D-40	1 "	107168-0-00		D-82	Cutter <i>3/4" 19.05</i>	1 "	107207-0-01	
D-42	Cutter Clutch Spring	1 "	107169-0-01		D-82	Cutter <i>1/2" 25.225</i>	1 "	109838-0-01	
D-43	Cutter Clutch Holder Plate	1 "	107165-0-01		D-82	Cutter <i>1" 21.425</i>	1 "	107210-0-01	
D-44	Set Screw for D-43	2 pcs.	100264-0-01					107197001-705234001	
D-45	Set Screw for D-46	1 pce.	107171-0-01					108224001-714057001	

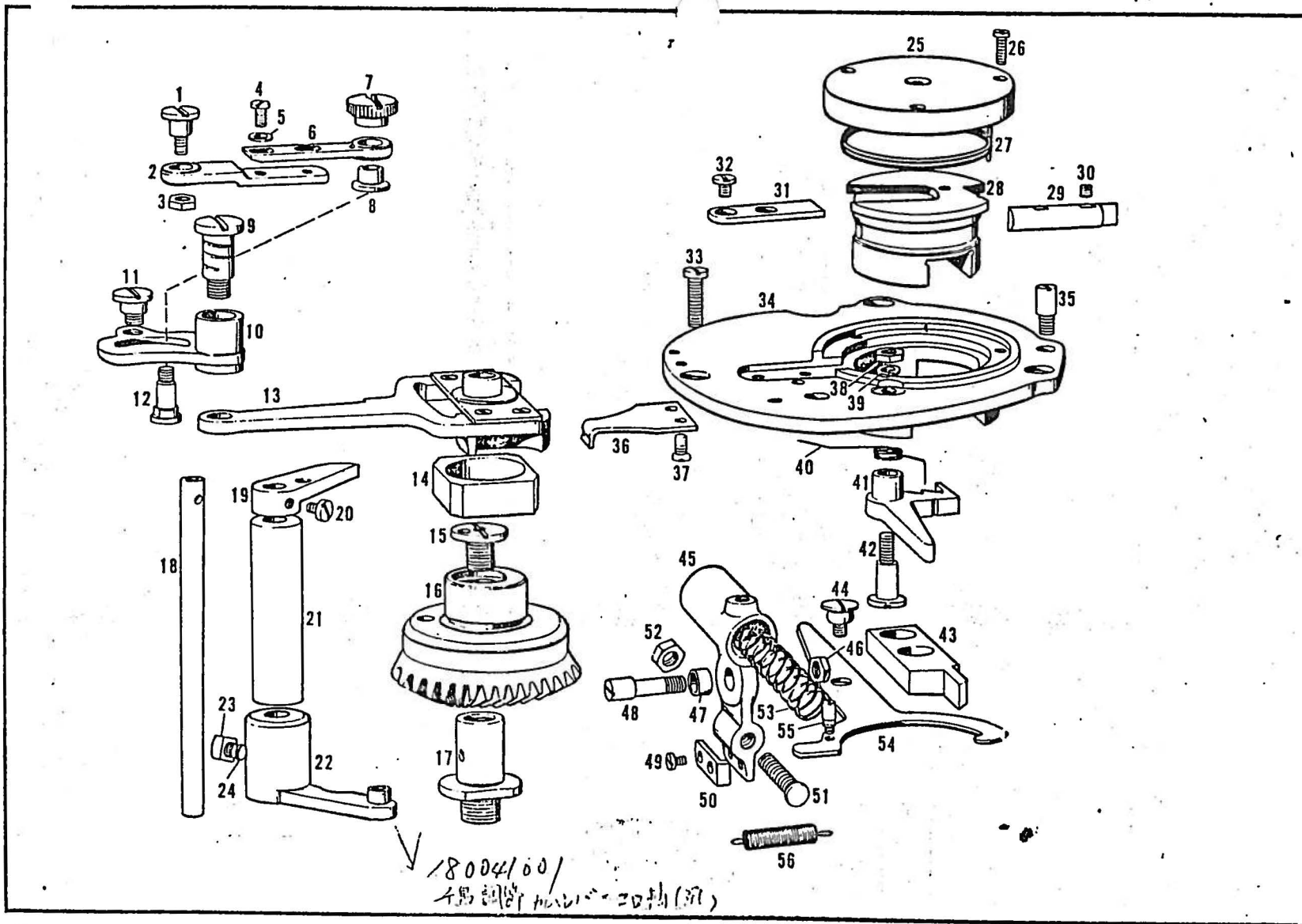



Ref. No.	Name of Parts	Q'ty	Parts No.	Assembl, No.	Ref. No.	Name of Parts	Q'ty	Parts No.	Asse. No.
E-1	Stud Screw for Needle Bar Support	1 pce.	107256-0-01		E-45	Zigzag Transverse	1 pce.	107279-0-01	
E-2	Zigzag Oscillating Connecting Bar (B)	1 "	107253-0-01		E-46	Nut for E-48	1 "	107282-0-01	
E-3	Nut for E-1	1 "	105234-0-01		E-47	Bush for E-48	1 "	107281-0-01	
E-4	Set Screw for E-2 & E-6	2 pcs.	101629-0-02		E-48	Zigzag Transverse Shaft	1 "	107280-0-01	
E-5	Washer for E-4	2 "	103847-0-03		E-49	Set Screw for E-50	2 pcs.	105219-0-03	
E-6	Zigzag Oscillating Connecting Bar (A)	1 pce.	107252-0-01		E-50	Zigzag Transverse Cam Finger	1 pce.	107283-0-01	
E-7	Thumb Nut for E-12	1 "	107251-0-01		E-51	Stopper for E-45	1 "	108286-0-01	107286
E-8	Bush for E-12	1 "	107249-0-01		E-52	Nut for E-51	1 "	100090-0-03	
E-9	Zigzag Oscillating Crank Connecting Stud	1 "	107248-0-01		E-53	Zigzag Transverse Stopper Spring	1 "	107289-0-01	
E-10	Zigzag Oscillating Crank	1 "	107246-0-01		E-54	Zigzag Regulator Trigger	1 "	107268-0-01	
E-11	Stud Screw for E-13	1 "	107247-0-01		E-55	Spring Sustainer (A) for E-54	1 "	107269-0-01	
E-12	Zigzag Oscillating Crank Shaft	1 "	107250-0-01		E-56	Spring for E-54	1 "	107270-0-01	
E-13	Zigzag Fork Assembly	1 "	107081-0-01	180037-0-01					
E-14	Zigzag Sleeve	1 set.	107239-0-00						
E-15	Cap Screw for E-17	1 pce.	107238-0-01						
E-16	Zigzag Bevel Gear (A)	1 "	107236-0-01	107083-0-01					
E-17	Zigzag Bevel Gear Shaft	1 "	107237-0-01						
E-18	Zigzag Regulator Cam Lever Shaft	1 "	107292-0-01						
E-19	Zigzag Regulator Trigger Holder	1 "	107290-0-01						
E-20	Set Screw for E-19	1 "	107291-0-01						
E-21	Bush for E-18	2 pcs.	107297-0-01						
E-22	Zigzag Regulator Cam Lever	1 pce.	107293-0-01						
E-23	Set Screw for E-22	1 "	107296-0-01						
E-24	Pusher for E-23	2 pcs.	101028-0-00						
E-25	Zigzag Regulator Body Cover	1 "	107277-0-01						
E-26	Set Screw for E-25	3 pcs.	107278-0-02						
E-27	Spring for E-28	1 pce.	107276-0-01						
E-28	Zigzag Regulator	1 "	107259-0-01						
E-29	Zigzag Transverse Rod	1 "	107260-0-01						
E-30	Set Screw for E-29	1 "	107053-0-01						
E-31	Zigzag Regulator Control Plate	1 "	107262-0-01						
E-32	Set Screw for E-31	1 "	107263-0-01						
E-33	Set Screw for E-34	3 pcs.	107274-0-01						
E-34	Zigzag Regulator Body	1 pce.	107273-0-01						
E-35	Position Screw for E-34	1 "	107275-0-01						
E-36	Spring Sustainer (B) for E-56	1 "	107271-0-01						
E-37	Set Screw for E-36	2 pcs.	107272-0-01						
E-38	Nut for E-42	1 pce.	107266-0-01						
E-39	Spring Washer E-38	1 "	101046-0-03	10196600	114290				
E-40	Spring for E-41	1 "	107267-0-01						
E-41	Zigzag Regulator Control Claw	1 "	107264-0-01						
E-42	Stud Screw for E-41	1 "	107265-0-01						
E-43	Zigzag Slide Brace	1 "	107258-0-01						
E-44	Ball Stud Screw for E-45	2 pcs.	107285-0-01						

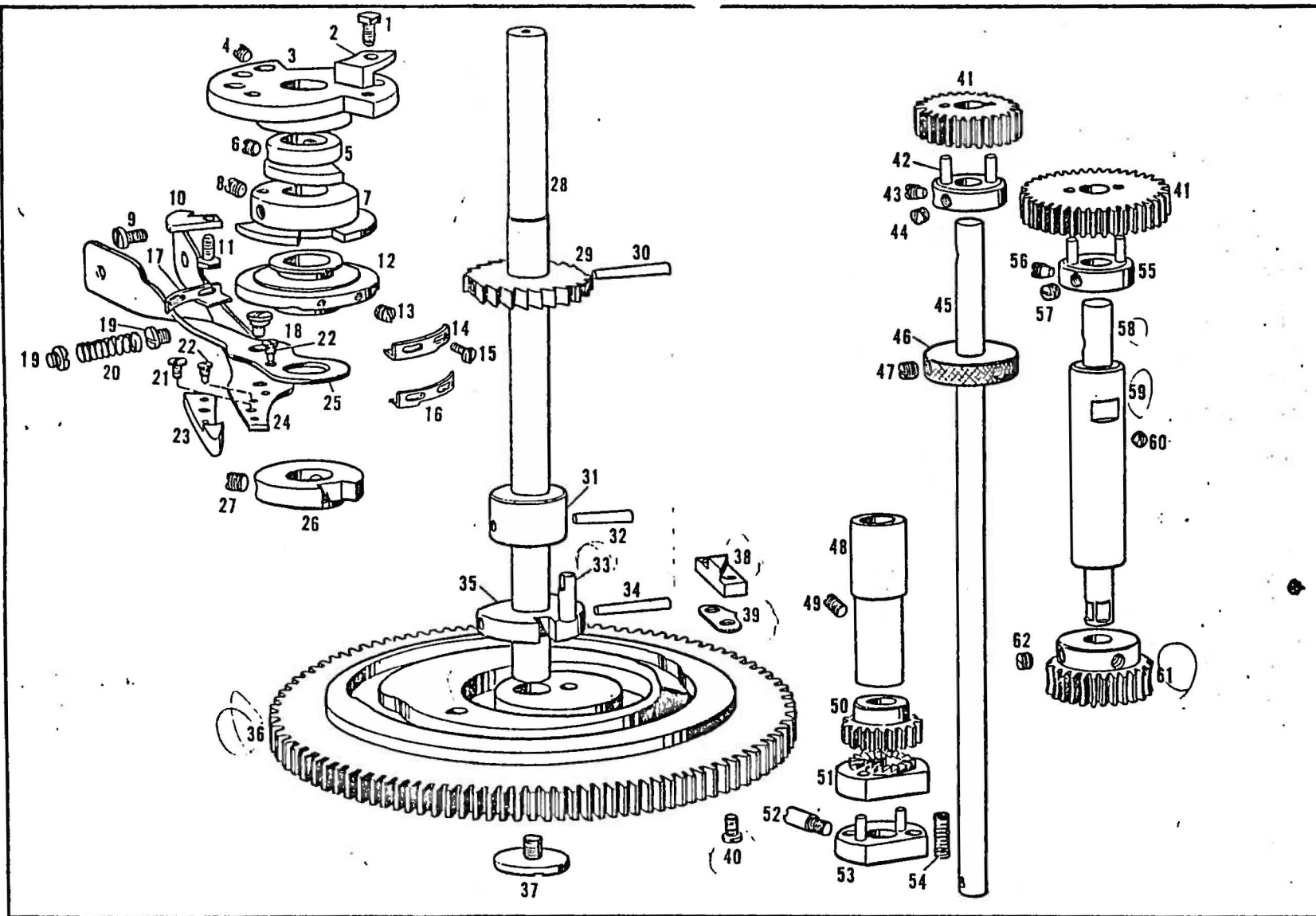



Ref. No.	Name of Parts	Q'ty	Parts No.	Assembly No.	Ref. No.	Name of Parts	Q'ty	Parts No.	Assembly No.
F-1	Bolt for F-2	1 pce.	107357-0-01		F-41	Transverse Gear 24	1 pce.	108821-0-01	
F-2	Zigzag Transverse Cam Segment	1 //	107356-0-01		F-41	Transverse Gear 46 <sup>26</sup>	1 //	108822-0-01	
F-3	Zigzag Transverse Cam	1 //	107354-0-01	107179-0-01	F-41	Transverse Gear 30	1 //	107340-0-00	
F-4	Set Screw for F-3	2 pcs.	107045-0-01		F-41	Transverse Gear 40	1 //	107341-0-00	
F-5	Cutter Cam	1 pce.	107358-0-01		F-41	Transverse Gear 28	1 //	108823-0-01	
F-6	Set Screw for F-5	2 pcs.	100289-0-01		F-41	Transverse Gear 32	1 //	108824-0-00	
F-7	Zigzag Regulator Cam	1 pce.	107360-0-01		F-41	Transverse Gear 34	1 //	108825-0-00	
F-8	Set Screw for F-7	1 //	100013-0-03		F-41	Transverse Gear 36	1 //	108826-0-00	
F-9	Set Screw for F-7	1 //	107362-0-02		F-41	Transverse Gear 38	1 //	108827-0-00	
F-10	Zigzag Regulator Cam Segment	1 //	107363-0-01		F-41	Transverse Gear 42	1 //	108828-0-00	
F-11	Bolt for F-10	1 //	107357-0-01		F-41	Transverse Gear 44	1 //	108829-0-00	
F-12	Thread Tension Release Cam	1 //	107365-0-01		F-41	Transverse Gear 46	1 //	108830-0-00	
F-13	Set Screw for F-12	2 pcs.	100289-0-01		F-42	Worm Wheel Shaft Collor Assembly	1 //	107136-0-01	
F-14	Thread Tension Release Cam Segment (A)	1 pce.	109736-0-01		F-43	Set Screw for F-42	1 //	107305-0-01	
F-15	Set Screw for F-14 & F-17 or F-16	4 pcs.	100080-0-03		F-44	Set Screw for F-42	1 //	107306-0-01	
F-16	Thread Tension Release Cam Segment (C)	1 pce.	109738-0-03		F-45	Gear Transverse Shaft	1 //	107323-0-01	
F-17	Thread Tension Release Cam Segment (B)	1 //	109737-0-01		F-46	Knurled Ring for F-45	1 //	107328-0-01	181989-0-01
F-18	Stud Screw for F-24 & F-25	1 //	107373-0-01		F-47	Set Screw for F-46	2 pcs.	100013-0-01	
F-19	Guide Screw for F-20	2 pcs.	107377-0-01		F-48	Gear Transverse Bush	1 pce.	107342-0-01	
F-20	Spring for F-24 & 25	1 pce.	107376-0-01		F-49	Set Screw for F-48	1 //	107343-0-01	
F-21	Set Screw for F-23	1 //	100257-0-07	107224-0-01	F-50	Gear Transverse Shaft Pinion Gear	1 //	107335-0-01	
F-22	Stopper for F-24 & F-25	3 pcs.	107370-0-01		F-51	Gear Transverse Shaft Ratchet	1 //	107333-0-01	
F-23	Claw for F-24	1 pce.	107374-0-01		F-52	Set Screw for F-50	1 //	107332-0-01	
F-24	Hand Ratchet Lever	1 //	107371-0-01		F-53	Collar With Guide Pin for F-5	1 //	107330-0-00	
F-25	Hand Lever	1 //	107369-0-01		F-54	Spring for F-53	2 pcs.	107334-0-01	
F-26	Upper Thread Scissor Cam	1 //	107380-0-01		F-55	Warm Wheel Shaft Collar Assembly	1 pce.	107136-0-01	
F-27	Set Screw for F-26	2 pcs.	100013-0-03		F-56	Set Screw for F-55	1 //	107305-0-01	
F-28	Cam Shaft	1 pce.	107352-0-01		F-57	Set Screw for F-55	1 //	107306-0-01	
F-29	Hand Ratchet	1 //	107378-0-01		F-58	Worm wheel Shaft	1 //	107302-0-01	
F-30	Taper Pin for F-29	1 //	107379-0-01		F-59	Worm Wheel Shaft Bush	1 //	107307-0-01	181968-0-01
F-31	Cam Shaft Collar	1 //	107382-0-01		F-61	Worm Wheel	1 //	107490-0-01	
F-32	Taper Pin for F-31	1 //	107383-0-01		F-60	Set Screw for F-57	1 //	107308-0-01	
F-33	Knock Pin for E-36	1 //	107345-0-01		F-62	Set Screw for F-61	2 pcs.	100251-0-01	
F-34	Taper Pin for F-35	1 //	107351-0-01						
F-35	Cam Shaft Gear Collar	1 //	107350-0-01						
F-36	Cam Shaft Gear	1 //	108831-0-01						
F-37	Set Screw for F-36	1 //	107349-0-01						
F-38	Stop Cam	1 //	107346-0-01						
F-39	Washer for F-40	2 pcs.	107778-0-01						
F-40	Set Screw for F-38	2 //	105173-0-02						
F-41	Transverse Gear 22	1 pce.	107336-0-00						
F-41	Transverse Gear 48	1 //	107337-0-00						

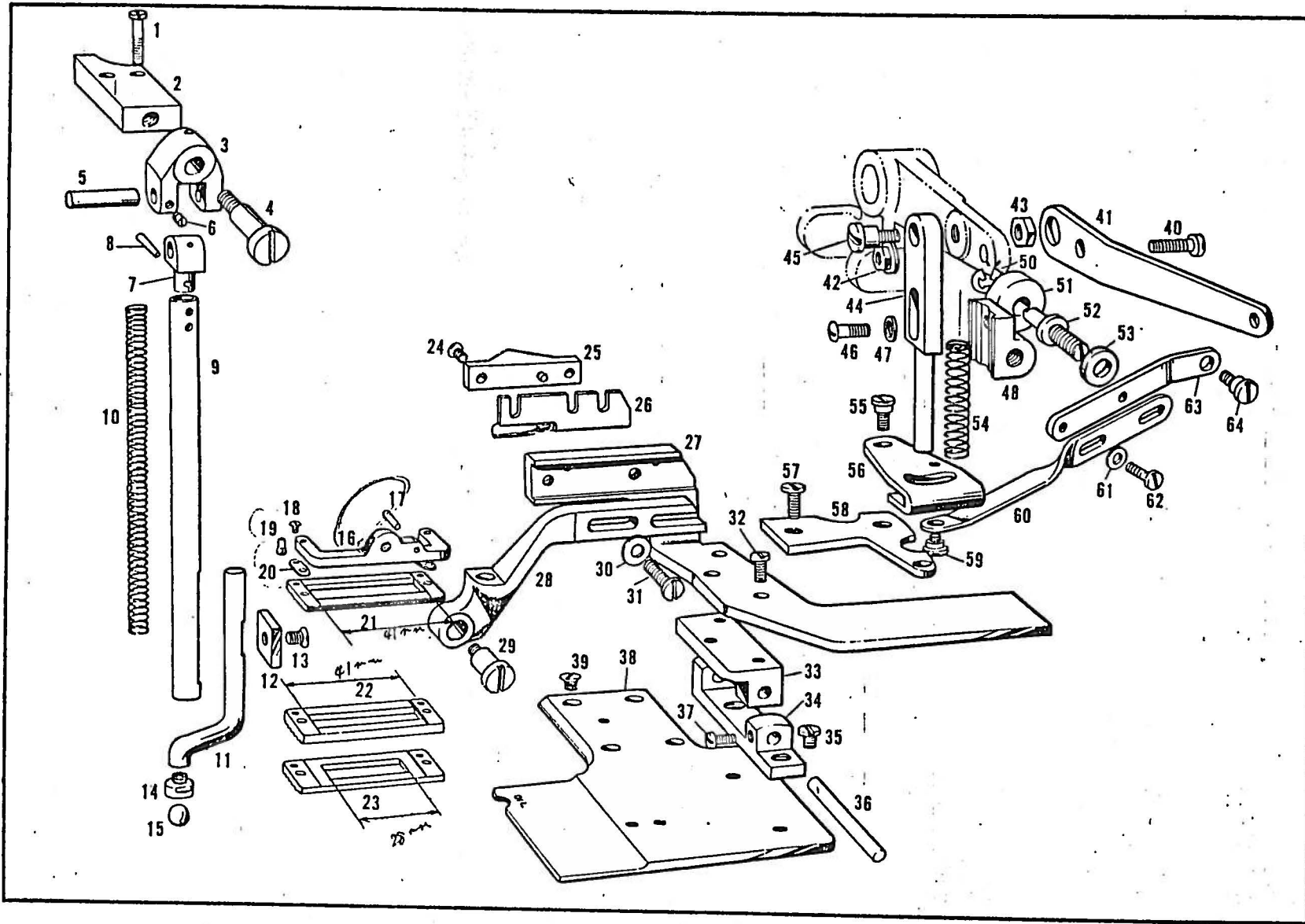



Ref. No.	Name of Parts	Q'ty	Parts No.	Assembly No.	Ref. No.	Name of Parts	Q'ty	Parts No.	As. No.	Qty
G-1	Set Screw for G-2	2 pcs.	107385-0-01		G-46	Set Screw for G-48	1 pcs.	107196-0-01		
G-2	Presser Bar Sleeve Hanger Bracket	1 pce.	107384-0-01		G-47	Washer for G-46	1 //	107348-0-01	107243-0-01	
G-3	Presser Bar Sleeve Hanger	1 //	107386-0-01		G-48	Supporter for G-52	1 //	107430-0-01		
G-4	Stud Screw for G-3	1 //	107387-0-01		G-50	Stop ling	1 //	111825-0-01		
G-5	Presser Bar Sleeve Hinge Pin	1 //	107388-0-01		G-51	Clamp Lift Roller	1 //	107425-0-01	180043-0-01	
G-6	Set Screw for G-5	1 //	104649-0-01	107233-0-01	G-52	Clamp Lift Roller Stud	1 //	107426-0-01		
G-7	Presser Bar Sleeve Hinge	1 //	107390-0-01		G-53	Washer for G-52	1 //	107427-0-01	107243-0-01	
G-8	Tapar Pin for G-7	1 //	115739-0-01		G-54	Spring for G44	1 //	107436-0-01		
G-9	Presser Bar Sleeve	1 //	107392-0-01		G-55	Stud Screw for G-56	1 //	107438-0-01		
G-10	Presser Spring	1 //	107393-0-01		G-56	Clamp Lift Control Plate	1 //	107437-0-01		
G-11	Pressr Bar	1 //	107394-0-01		G-57	Set Screw for G-58	1 //	107440-0-01		
G-12	Presser Bar Yoke Plate	1 //	107396-0-01		G-58	Supporter for G-54	1 //	107439-0-01		
G-13	Set Screw for G-12	1 //	107397-0-01		G-59	Stud Screw for G-60	1 //	107442-0-01		
G-14	Presser Bar Ball Receiver	1 //	107395-0-01		G-60	Clamp Control Crank Bar (A)	1 //	107441-0-01		
G-15	Presser Bar Ball	1 //	107398-0-01		G-61	Washer for G-62	2 pcs.	107348-0-01		
G-16	Supporter for G-21	1 //	107400-0-01		G-62	Set Screw for G-60 & G-63	2 //	107407-0-02		
G-17	Stopper Pin for G-16	1 //	107402-0-01		G-63	Clamp Control Crank Bar (B)	1 pce.	107445-0-01		
G-18	Set Screw for G-20	2 pcs.	107401-0-01	109660-0-01	G-64	Stud Screw for G-63	1 //	107438-0-01		
G-19	Set Pin for G-16	2 //	107403-0-01							
G-20	Plate Spring for G-16	2 //	107401-0-01							
G-21	Upper Clamping Foot (A)	1 pce.	107399-0-01							
G-22	Upper Clamping Foot (B)	1 //	107446-0-01							
G-23	Upper Clamping Foot (C)	1 //	108833-0-01							
G-24	Set Screw for G-25	1 //	107413-0-01							
G-25	Upper Thread Scissor Releasing Cam	1 //	107411-0-01							
G-26	Upper Thread Scissor Lifter Plate	1 //	107410-0-01							
G-27	Clamp Lifter	1 //	107409-0-01							
G-28	Clamp Lever	1 //	107406-0-01							
G-29	Stud Screw for G-16	1 //	107405-0-01							
G-30	Washer for G-31	2 pcs.	107348-0-01							
G-31	Set Screw for G-28	2 //	107407-0-02							
G-32	Set Screw for G-27	3 pcs.	101629-0-02							
G-33	Bracket for G-27	1 pce.	107414-0-01							
G-34	Clamp Lift Lever Yoke	1 //	107418-0-01	180042-0-01						
G-35	Set Screw for G-34	2 pce.	107419-0-01							
G-36	Shaft for G-33	1 pce.	107416-0-01							
G-37	Set Screw for G-36	1 //	107135-0-01							
G-38	Clamping Base Plate	1 //	107420-0-01							
G-39	Set Screw for G-38	4 pcs.	107421-0-01							
G-40	Set Screw for G-41	1 pce.	107428-0-02							
G-41	Clamp Lift Lever	1 //	107422-0-01							
G-42	Nut for G-40	1 //	107424-0-01							
G-43	Nut for G-45	1 //	107114-0-01							
G-44	Clamp Control Bar	1 //	107433-0-01	107243-0-01						
G-45	Stud Screw for G-44	1 //	107434-0-01							

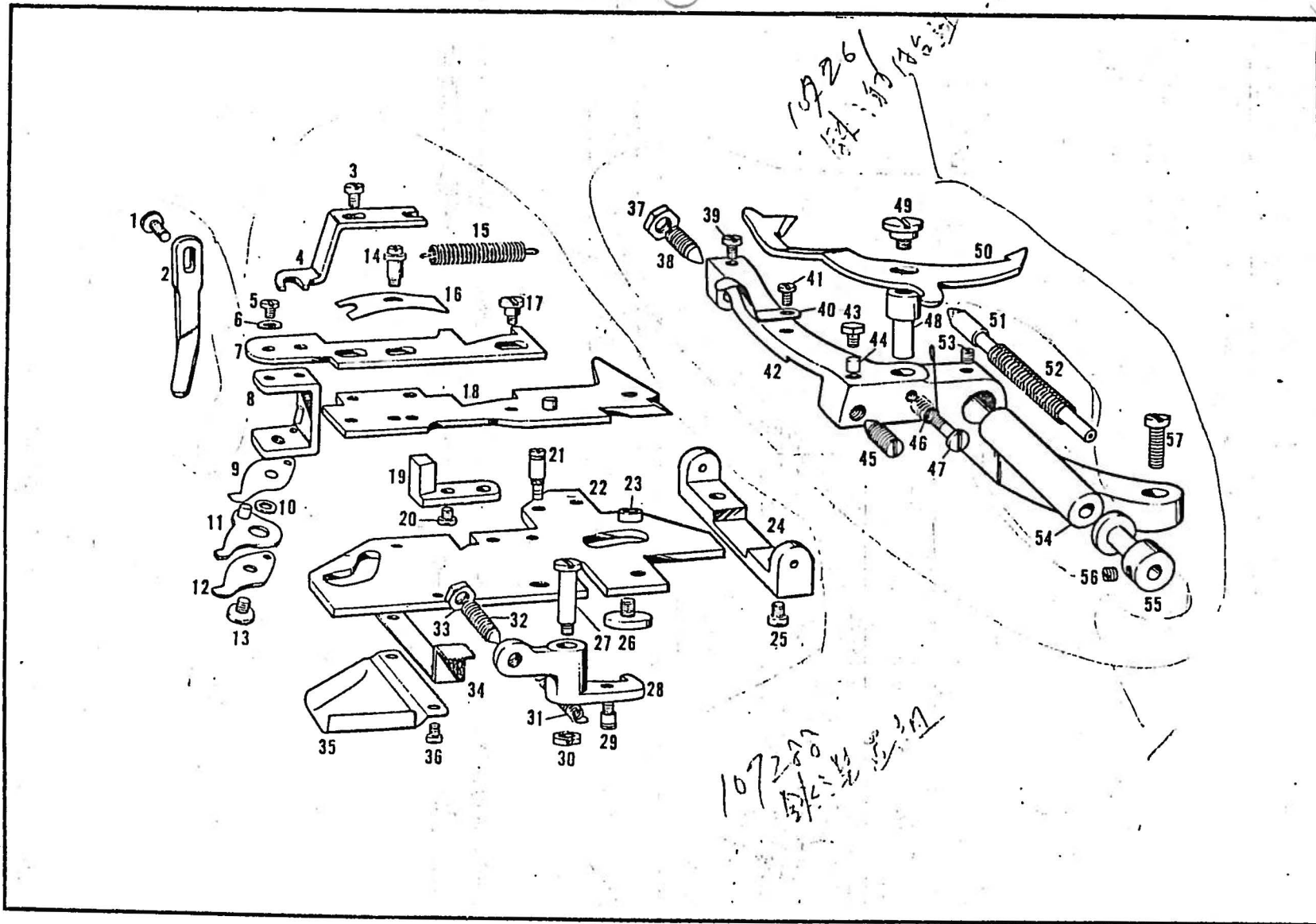



Ref. No.	Name of Parts	Q'ty	Parts No.	Assembly No.	Ref. No.	Name of Parts	Q'ty	Parts No.	Assembly No.
H-1	Set Screw for H-2	1 pce.	107407-0-02		H-45	Centre Screw for H-42 (right)	1 pce.	107486-0-01	
H-2	Thread Scissor Device Guider	1 "	107527-0-01		H-46	Spring for H-50	1 "	107475-0-01	
H-3	Set Screw for H-4	2 pcs.	107526-0-01		H-47	Set Screw for H-48	1 "	107474-0-01	
H-4	Thread Scissor Motion Shank	1 pce.	107525-0-01		H-48	Fulcrum Stud for H-50	1 "	107472-0-01	
H-5	Set Screw for H-8	2 pcs.	105123-0-01	107288-0-01	H-49	Stud Screw for H-50	1 "	107473-0-01	
H-6	Washer for H-5	2 "	103847-0-03		H-50	Thread Scissor Device Check Lever	1 "	107471-0-01	
H-7	Thread Scissor Slide Upper Plate	1 pce.	107509-0-01		H-51	Thread Scissor Device Centre Rod	1 "	107477-0-01	107261-0-01
H-8	Thread Scissor Yoke	1 "	182215-0-01		H-52	Spring for H-51	1 "	107480-0-01	
H-9	Thread Scissor Upper Plate	2 pcs.	107522-0-01		H-53	Set Screw for H-54	1 "	104649-0-01	
H-10	Collar for H-11	1 pce.	107523-0-01	182200-0-01	H-54	Thread Scissor Device Centre Bush	1 "	107481-0-01	
H-11	Thread Scissor Middle Blade	1 "	107519-0-01		H-55	Collar for H-51	1 "	107478-0-01	
H-12	Thread Scissor Lower Blade	2 pcs.	107518-0-01		H-56	Set Screw for H-55	1 "	104649-0-01	
H-13	Set Screw for H-9 H-11 & H-12	1 pce.	107524-0-01		H-57	Set Screw for H-42	2 pcs.	107470-0-01	
H-14	Sustainer Screw for H-16 or H-18	1 "	107512-0-01						
H-15	Spring for H-7 & H-18	1 "	107513-0-01						
H-16	Plate Spring for H-7	1 "	107511-0-01						
H-17	Stud Screw for H-18	2 pcs.	107510-0-01						
H-18	Thread Scissor Slide Lower Plate	1 pce.	107507-0-01						
H-19	Stopper for H-22	1 "	107493-0-01						
H-20	Set Screw for H-19	2 pcs.	107494-0-01						
H-21	Sustainer for H-31 or H-22	1 pce.	107501-0-01						
H-22	Thread Scissor Slide Base Plate	1 "	107492-0-01	107288-0-01					
H-23	Roller for H-22	2 pcs.	107503-0-01						
H-24	Thread Scissor Reciprocating Block	1 pce.	107485-0-01						
H-25	Set Screw for H-24	2 pcs.	107491-0-02						
H-26	Set Screw for H-23	2 "	107502-0-01						
H-27	Stud Screw for H-28	1 pce.	107496-0-01						
H-28	Thread Scissor Slide Plate Backlash Stopper	1 "	107495-0-01						
H-30	Nut for H-27	1 "	107444-0-02						
H-29	Sustainer for H-31 or H-28	1 "	107500-0-01						
H-31	Spring for H-28	1 "	107499-0-01						
H-32	Adjusting Screw for H-28	1 "	107497-0-01						
H-33	Nut for H-32	1 "	107498-0-01						
H-34	Thread Scissor Device Lift Latch	1 "	107504-0-01						
H-35	Thread Scissor Device Lower Cover	1 "	107506-0-01						
H-36	Set Screw for H-34 & H-35	2 pcs.	107494-0-01						
H-37	Nut for H-38	1 "	100090-0-01						
H-38	Centre Screw for H-42 (left)	1 "	100333-0-01						
H-39	Stop Screw for H-50	1 "	107476-0-01						
H-40	Thread Scissor Device Plate Spring	1 "	107483-0-01						
H-41	Set Screw for H-40	1 "	100257-0-00						
H-42	Thread Scissor Device Yoke	1 "	107469-0-01	107261-0-01					
H-43	Bolt for H-45	1 "	107488-0-02						
H-44	Pusher for H-43	1 "	107487-0-00						

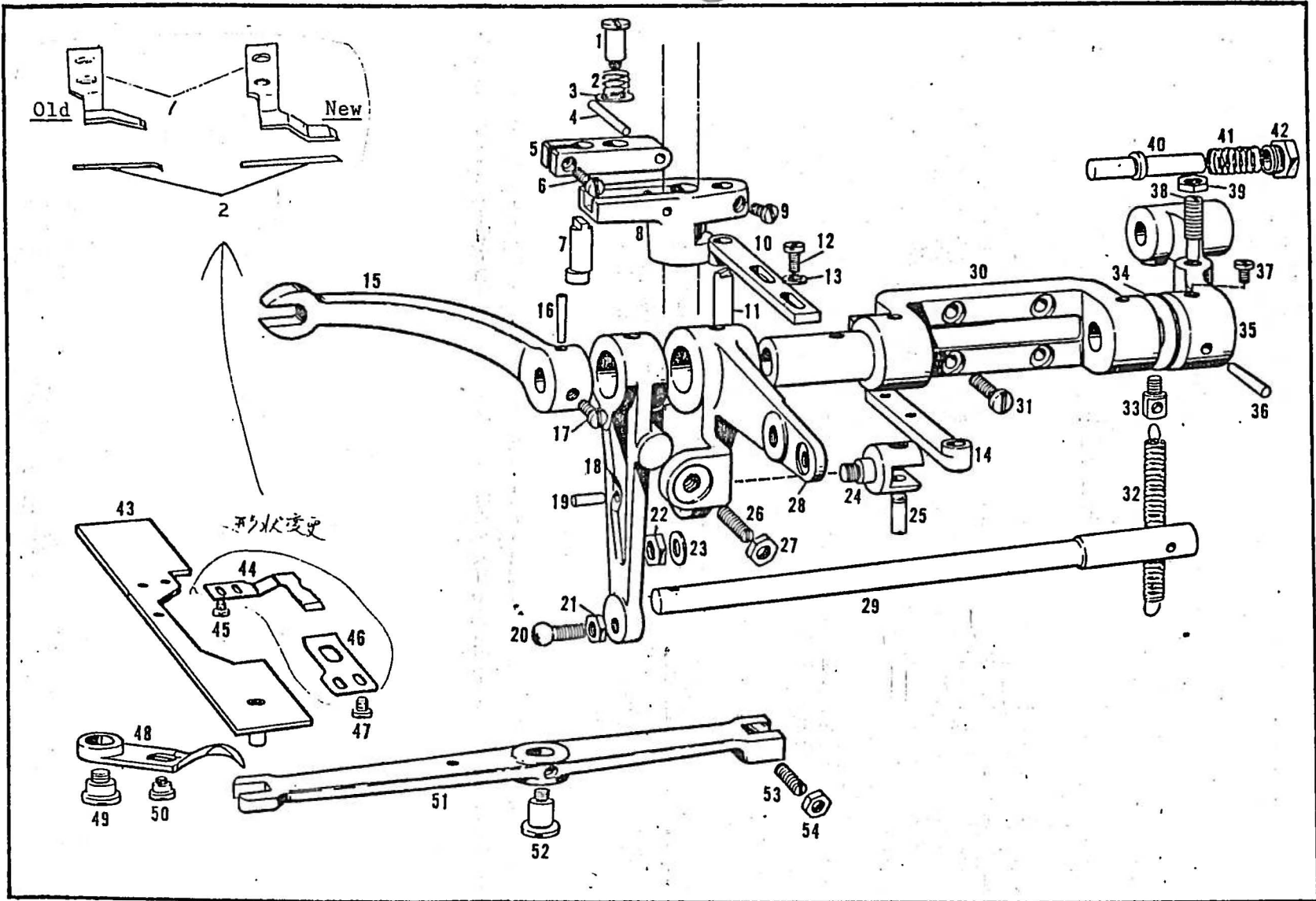



Ref. No.	Name of Parts	Q'ty	Parts No.	Asset No.	Ref. No.	Name of Parts	Q'ty	Parts No.	As'y
I-1	Stud Screw for I-2 上糸止ねじ	1 pce.	107467-0-01		I-43	Lower Thread Cutter Slide Plate	1 pce.	107539-0-01	
I-2	Spring for I-5 上糸バネ	1 "	107466-0-01		I-44	Lower Thread Cutter Movable Blade	2 pcs.	107541-0-01	
I-3	Washer for I-2 上糸ワッシャー	1 "	107408-0-01		I-45	Set Screw for I-44	2 "	105288-0-03	
I-4	Pin for I-5 上糸ピン	1 "	107462-0-00	107257001	I-46	Lower Thread Cutter Fixed Blade	1 pce.	107546-0-01	
I-5	Thread Scissor Pushing Lever 上糸	1 "	107461-0-01		I-47	Set Screw for I-46	2 pcs.	103961-0-00	
I-6	Clamp Screw for I-7 上糸クリップねじ	1 "	107465-0-01	上糸	I-48	Lower Thriad Release I-48 上糸リリース	1 pce.	107543-0-01	
I-7	Roller Pin for I-5 上糸ローラーピン	1 "	107463-0-01	上糸	I-49	Stud Screw for I-48	1 "	107544-0-01	
I-8	Thread Scissor Pushing Lever Body 上糸	1 "	107460-0-01	上糸	I-50	Stud Screw for I-48	1 "	107545-0-01	
I-9	Set Screw for I-11 上糸	1 "	107459-0-01		I-51	Lower Thread Cutter Lever	1 "	107535-0-01	
I-10	Upper Thread Cutter 上糸切歯 上 Connecting Bar (B)	1 "	107455-0-01		I-52	Stud Screw for I-51	1 "	107536-0-01	
I-11	Hinge Pin for I-8	1 "	107458-0-01		I-53	Stop Screw for I-51	1 "	100016-0-03	
I-12	Set Screw for I-10 & I-14 上糸	2 pcs.	101629-0-02		I-54	Nut for I-53	1 "	107114-0-01	
I-13	Washer for I-12 上糸ワッシャー	2 "	103847-0-04						
I-14	Upper Thread Cutter 上糸切歯 下 Connecting Bar (A)	1 pce.	107454-0-01						
I-15	Upper Thread Tension Release Arm	1 "	107641-0-01						
I-16	Taper Pin I-15	1 "	107643-0-00						
I-17	Set Screw for I-15	1 "	107631-0-01						
I-18	Lower Thread Cutter Motion Lever	1 "	107529-0-01						
I-19	Pin for I-18	1 "	107530-0-00						
I-20	Ball Stud Screw for I-18	1 "	107533-0-01						
I-21	Nut for I-20	1 "	107114-0-01						
I-22	Nut for I-24	1 "	107282-0-01						
I-23	Washer for I-24	1 "	107453-0-01						
I-24	Upper Thread Cutter Crank Joint 上糸切歯	1 "	107450-0-01	上糸切歯					
I-25	Pin for I-24	1 "	107451-0-01						
I-26	Adjusting Screw for I-28	2 pcs.	107976-0-01						
I-27	Nut for I-26	2 "	107282-0-01						
I-28	Upper Thread Cutter Lever	1 pce.	107449-0-01						
I-29	Upper Thread Tension Release Lever Shaft	1 "	107628-0-01						
I-30	Upper Thread Cutter Lever Bracket	1 "	107447-0-01						
I-31	Set Screw for I-30	4 pcs.	107423-0-01						
I-32	Spring for I-35	1 pce.	107638-0-01						
I-33	Suspender on I-15	1 "	107639-0-01						
I-34	Washer for I-30	1 "	107629-0-01						
I-35	Upper Thread Tension Release Lever	1 "	107630-0-01						
I-36	Taper Pin I-35	1 "	107383-0-01						
I-37	Set Screw for I-35	1 "	107631-0-01						
I-38	Adjusting Stopper for I-35	1 "	107636-0-01						
I-39	Nut for I-38	1 "	107114-0-01						
I-40	Pin for I-35	1 "	107633-0-01						
I-41	Spring for I-40	1 "	107634-0-01						
I-42	Cap Screw for I-41	1 "	107635-0-01						

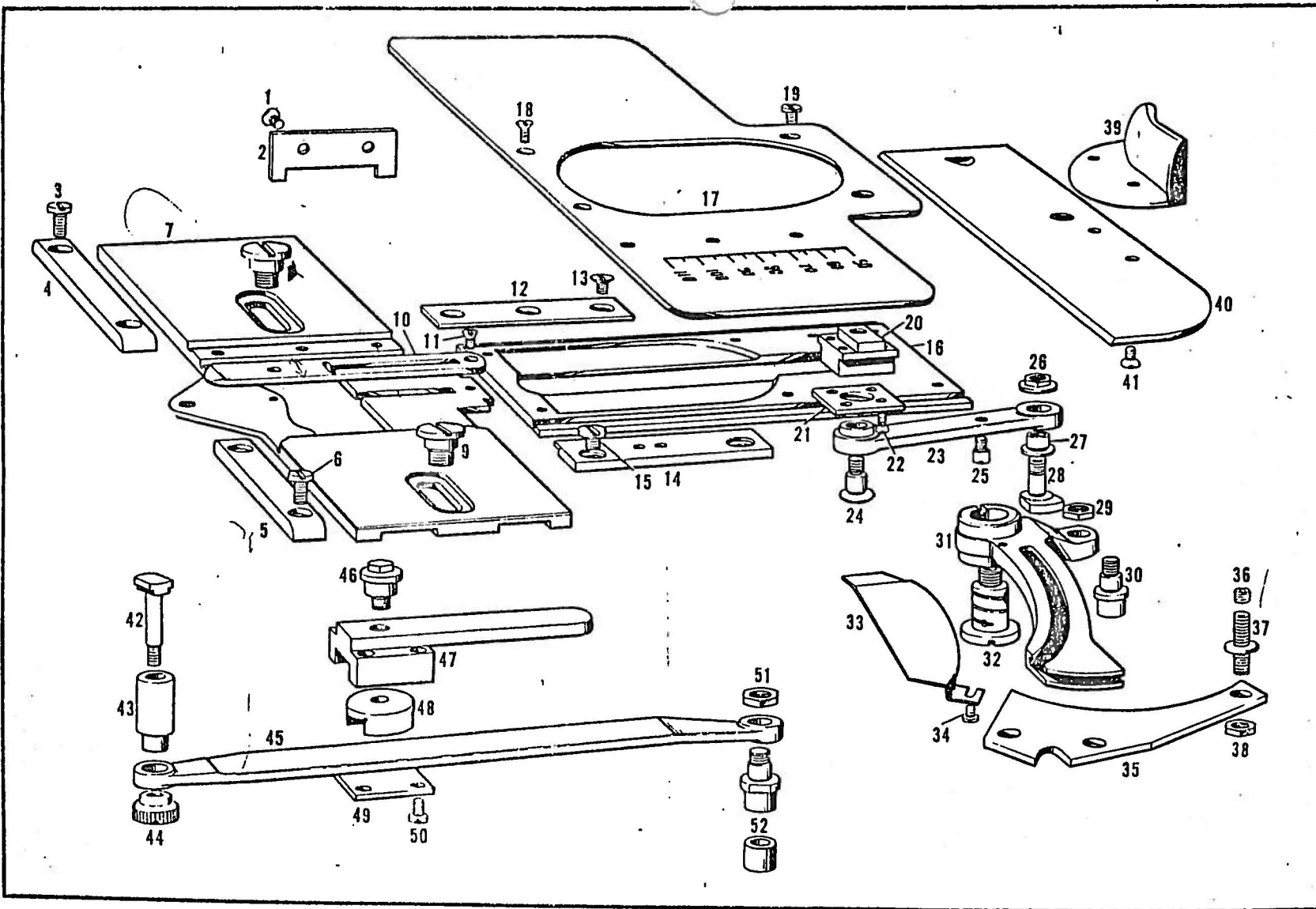



Ref. No.	Name of Parts	Q'ty	Parts No.	Assembly No.	Ref. No.	Name of Parts	Q'ty	Parts No.	Assembly No.
J-1	Set Screw for J-2	2 pcs.	107397-0-01		J-46	Adjusting Screw for J-47	1 //	107576-0-01	
J-2	Plate for K-33	1 pce.	107600-0-01		J-47	Width Feed Regulator	1 pce.	107573-0-01	
J-3	Set Screw for J-4	2 pcs.	107407-0-02		J-48	Width Feed Regulator Sleeve Slot	1 //	107572-0-01	180046-0-01
J-4	Feed Base Plate Guider (left)	1 pce.	107592-0-01		J-49	Width Feed Regulator Cover	1 //	107574-0-01	
J-5	Feed Base Plate Guider (right)	1 //	107590-0-01		J-50	Set Screw for J-49	4 pcs.	107575-0-01	
J-6	Set Screw for J-5	2 pcs.	107407-0-02		J-51	Nut for J-52	1 pce.	107114-0-01	
J-7	Feed Base Plate	1 pce.	107581-0-01		J-52	Width Feed Roller With Stud	1 //	106003-0-01	180044-0-01
J-9	Stud Screw for J-7	2 pcs.	107588-0-01		J-52	Width Feed Roller Stud	1 //	107570-0-01	
J-10	Needle Plate (A)	1 pce.	107582-0-01						
J-10	Needle Plate (B)	1 pce.	107583-0-01						
J-11	Set Screw for Needle Plate	2 pcs.	107565-0-01						
J-12	Length Feed Guide (left)	1 pce.	107586-0-01						
J-13	Set Screw for J-12	3 pcs.	107587-0-01						
J-14	Length Feed Guide (right)	1 pce.	107584-0-01						
J-15	Set Screw for J-14	2 pcs.	107419-0-01						
J-16	Length Feed Plate	1 pce.	107580-0-01						
J-17	Feed Base Plate Cover	1 //	107591-0-01						
J-18	Set Screw for J-17	2 pcs.	107596-0-01						
J-19	Set Screw for J-17	2 //	108135-0-01						
J-20	Length Feed Slide Block	1 pce.	107563-0-01						
J-21	Cover for J-20	1 //	107564-0-01						
J-22	Set Screw for J-21	4 pcs.	107596-0-01						
J-23	Length Feed Link <i>to 1/2" x 1/8" x 1/4"</i>	1 pce.	107560-0-01						
J-24	Stud Screw for J-23	1 //	107562-0-01						
J-25	Position Screw for K-33 or J-23	1 //	107561-0-01						
J-26	Nut for J-28	1 //	107424-0-01						
J-27	Bush for J-28	1 //	107558-0-01						
J-28	Length Feed Adjusting Stud	1 //	107557-0-01						
J-29	Nut for J-30	1 //	107114-0-01						
J-30	Roller with Stud for J-31	1 //	182303-0-01	10755000					
J-31	Length Feed Regulator	1 //	107518-0-01						
J-32	Stud Screw for J-31	1 //	107549-0-01	182217-0-01					
J-33	Cover for J-31	1 //	107566-0-01						
J-34	Set Screw for J-33	2 pcs.	105288-0-03						
J-35	Position Plate for J-31	1 pce.	107553-0-01						
J-36	Set Screw for J-37	3 pcs.	107555-0-01						
J-37	Stud Screw for J-35	3 //	107554-0-01						
J-38	Nut for J-37	3 //	107556-0-02						
J-39	Cam Shaft Cover	1 pce.	107598-0-01						
J-40	Length Regulator Slide Plate	1 //	107597-0-01						
J-41	Set Screw for J-39	2 pcs.	107397-0-01						
J-42	Width Feed Lever Stud Bush	1 pce.	107578-0-01						
J-43	Width Feed Lever Stud	1 //	107577-0-01						
J-44	Thumb Screw for J-42	1 //	107251-0-01						
J-45	Width Feed Lever	1 //	107568-0-01						



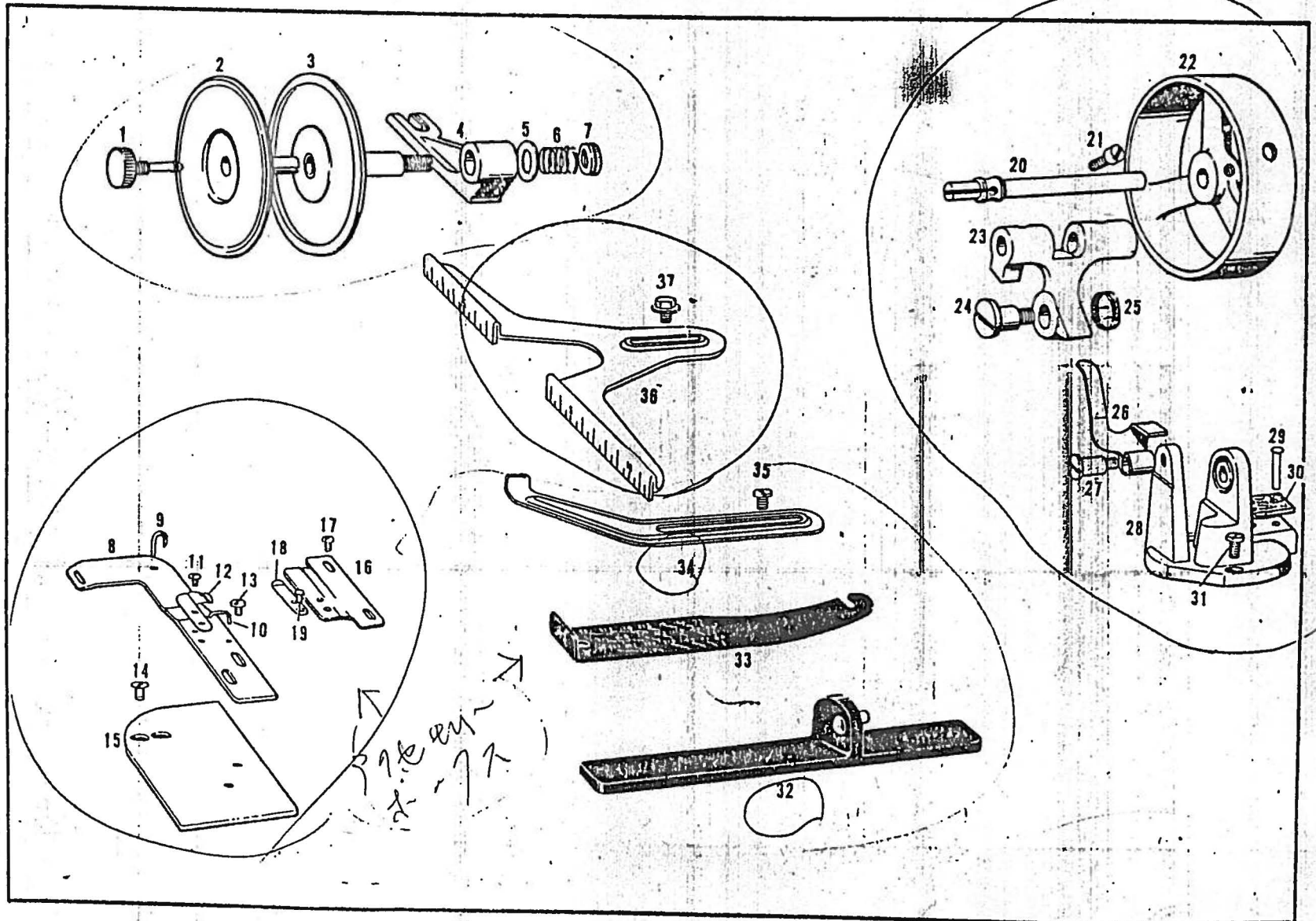



Ref. No.	Name of Parts	Q'ty	Parts No.	Assembly No.	Ref. No.	Name of Parts	Q'ty	Parts No.	Assembly No.
K-1	Tape Winder Thumb Screw	1 pce.	108492-0-01						
K-2	Tape Winder Flange Stud (B)	1 ♀	108487-0-01						
K-3	Tape Winder Flange Stud (A)	1 ♀	108486-0-01						
K-4	Tape Winder Holding Bracket	1 ♀	108493-0-01	108485-0-01					
K-5	Washer for K-3	1 ♀	108494-0-01						
K-6	Tape Winder Tension Spring	1 ♀	108495-0-01						
K-7	Nut for K-3	1 ♀	100136-0-01						
K-8	Tape Guide Plate	1 ♀	107698-0-01						
K-9	Tape Guide Side Wire (B)	1 ♀	107700-0-01						
K-10	Tape Guide Side Wire (A)	1 ♀	107699-0-01						
K-11	Set Screw for K-12	2 pcs.	107703-0-02						
K-12	Tape Guide Plate Spring for K-8	1 pce.	107702-0-01	107361-0-01					
K-13	Set Screw for K-8	2 pcs.	107491-0-02						
K-15	Tape Guide Base Plate	1 pce.	107696-0-01						
K-14	Set Screw for K-15	2 pcs.	107697-0-01						
K-16	Tape Needle Plate Guide	1 ♀	107704-0-01						
K-18	Tape Guide Plate Spring for K-16	1 ♀	107706-0-01	107364-0-01					
K-19	Pin for K-16	1 ♀	107320-0-01						
K-17	Set Screw for K-18	2 pcs.	107703-0-02	系 定 物					
K-20	Bobbin Winder Shaft	1 pce.	107670-0-01						
K-21	Set Screw for K-22	1 ♀	100025-0-01						
K-22	Bobbin Winder Wheel	1 ♀	106014-0-01						
K-23	Bobbin Winder Shaft Holding Bracket	1 ♀	107667-0-01						
K-24	Stud Screw for K-23	1 ♀	107668-0-01						
K-25	Spring for K-23	1 ♀	107669-0-01						
K-26	Bobbin Holder 糸 定 物	1 ♀	107673-0-01	107355-0-01					
K-27	Stud Screw for K-26	1 ♀	106022-0-01						
K-28	Bobbin Winder Body	1 ♀	107664-0-01						
K-29	Pin for K-30	2 pcs.	106027-0-00						
K-30	Bobbin Winder Brake Leather	1 pce.	106025-0-01						
K-31	Set Screw for K-28	2 pcs.	105173-0-02						
K-32	Position Plate for Plunge Spring Assembly	1 set.	107757-0-01						
K-33	Length Feed Gauge	1 pce.	107776-0-01						
K-34	Cloth Guide (A)	1 ♀	108530-0-01						
K-35	Set Screw for K-34	2 pcs.	108435-0-01						
K-36	Cloth Guide (B)	1 pce.	107443-0-01						
K-37	Set Screw for K-36	1 ♀	107456-0-01						



B812-24

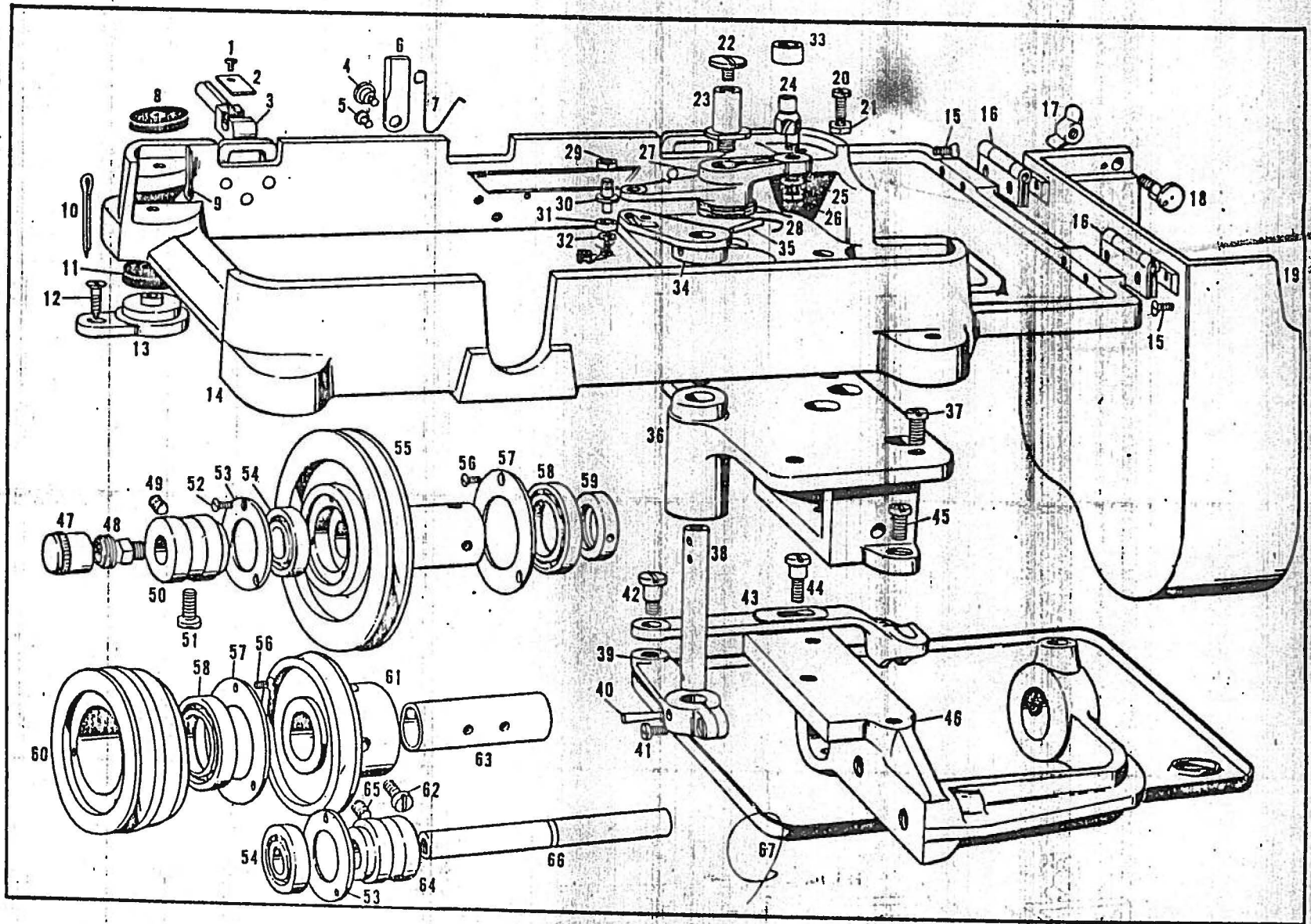



Ref. No.	Name of Parts	Q'ty	Parts No.	Assembly No.	Ref. No.	Name of Parts	Q'ty	Parts No.	Assembly No.
L-1	Set Screw for L-2	2 pcs.	105219-0-03		L-46	Transmitter Shaft Frame	1 pcc.	107758-0-01	
L-2	Head Hook Plate	2 "	107718-0-01	180045-0-01	L-47	Cover for L-48	1 "	107767-0-00	
L-3	Head Hook	2 "	107717-0-01		L-48	Transmitter Shaft Grease Cup	1 "	107766-0-00	
L-4	Stud Screw for L-6	1 pcc.	107721-0-01		L-49	Set Screw for L-50	1 "	100013-0-01	
L-5	Stop Screw for L-6	1 "	100665-0-01		L-50	Transmitter Bush (A)	1 "	107760-0-00	107389-0-01
L-6	Length Feed Gauge Presser Plate	1 "	107720-0-01		L-51	Set Screw for L-66	1 "	105351-0-02	
L-7	Notch Spring for L-6	1 "	107723-0-01		L-52	Set Screw for L-53	3 pcs.	102843-0-01	107327-10
L-8	Head Cushion	4 pcs.	107715-0-01		L-53	Cover for L-55	2 pcs.	107770-0-00	
L-9	Split Pin for L-8	4 "	107716-0-00		L-54	Ball Bearing for L-65	2 "	107769-0-00	
L-10	Split Pin for L-11	4 "	107714-0-00		L-55	V Pulley Large for L-55	1 pcc.	107768-0-00	
L-11	Base Cushion	4 "	107713-0-00		L-56	Set Screw for L-57	3 pcs.	102843-0-01	
L-12	Wood Screw for L-13	4 "	100469-0-02		L-57	Cover for L-60	2 pcs.	107775-0-00	
L-13	Base Cover Shoe Base	4 "	107711-0-01		L-58	Ball Bearing for L-60	2 "	107759-0-00	
L-14	Cover Assembly	1 set.	107366-0-01		L-59	Collar for L-58	1 pcc.	107774-0-00	
L-15	Set Screw for L-16	8 pcs.	107231-0-01		L-60	Belt Pulley Small (A)	1 "	107772-0-00	
L-16	Belt Cover Hinge	2 sets.	107372-0-01		L-61	Belt Pulley Small (B)	1 "	107777-0-00	
L-17	Wing Nut for L-18	1 pcc.	107727-0-01		L-62	Set Screw for L-61	2 pcs.	105173-0-01	
L-18	Belt Cover Stud Screw Assembly	1 set.	107368-0-01		L-63	Transmitter Shaft Collar	1 pcc.	107781-0-00	
L-19	Belt Cover	1 "	107724-0-01		L-64	Transmitter Bush (B)	1 "	107762-0-00	
L-20	Stop Screw for L-19	1 "	107732-0-02		L-65	Set Screw for L-64	1 "	100013-0-01	
L-21	Nut for L-20	2 pcs.	107733-0-01		L-66	Transmitter Shaft	1 "	107764-0-01	
L-22	Cap Screw for L-23	1 "	105155-0-01		L-67	Oil Pan	1 "	107457-0-01	
L-23	Belt Shift Lever Stud	1 pcc.	107736-0-00						
L-24	Roller Stud for L-27 (large)	1 "	107739-0-00						
L-25	Washer for L-24	1 "	101109-0-02						
L-26	Nut for L-24	1 "	100090-0-03	107375-0-01					
L-27	Belt Shift Lever	1 "	107738-0-01						
L-29	Nut for L-30	1 "	107282-0-01						
L-30	Roller Stud for L-27 (small)	1 "	107743-0-01						
L-31	Roller for L-27	1 "	107744-0-01	180048-0-01					
L-32	Stop Ring	1 "	102650-0-01						
L-33	Roller for L-24	1 "	100084-0-01	107375-0-01					
L-28	Spring for L-27	1 "	107756-0-01						
L-34	Belt Guide Cam Plate	1 "	107748-0-01						
L-35	Taper Pin for L-34	1 "	107749-0-00						
L-36	Transmitter Base	1 "	107731-0-01						
L-37	Set Screw for L-36	4 pcs.	107311-0-01						
L-38	Shaft for L-39	1 pcc.	107750-0-00						
L-39	Belt Shift Arm	1 "	107751-0-01						
L-40	Taper Pin for L-39	1 "	107752-0-00						
L-41	Clamp Screw for L-39	1 "	107753-0-02						
L-42	Stop Screw for L-39	1 "	107754-0-01						
L-43	Self Shifter	1 "	107755-0-01						
L-44	Stud Screw for L-43	1 "	108811-0-01						
L-45	Set Screw for L-49	3 pcs.	107311-0-01						